

HRH0928H

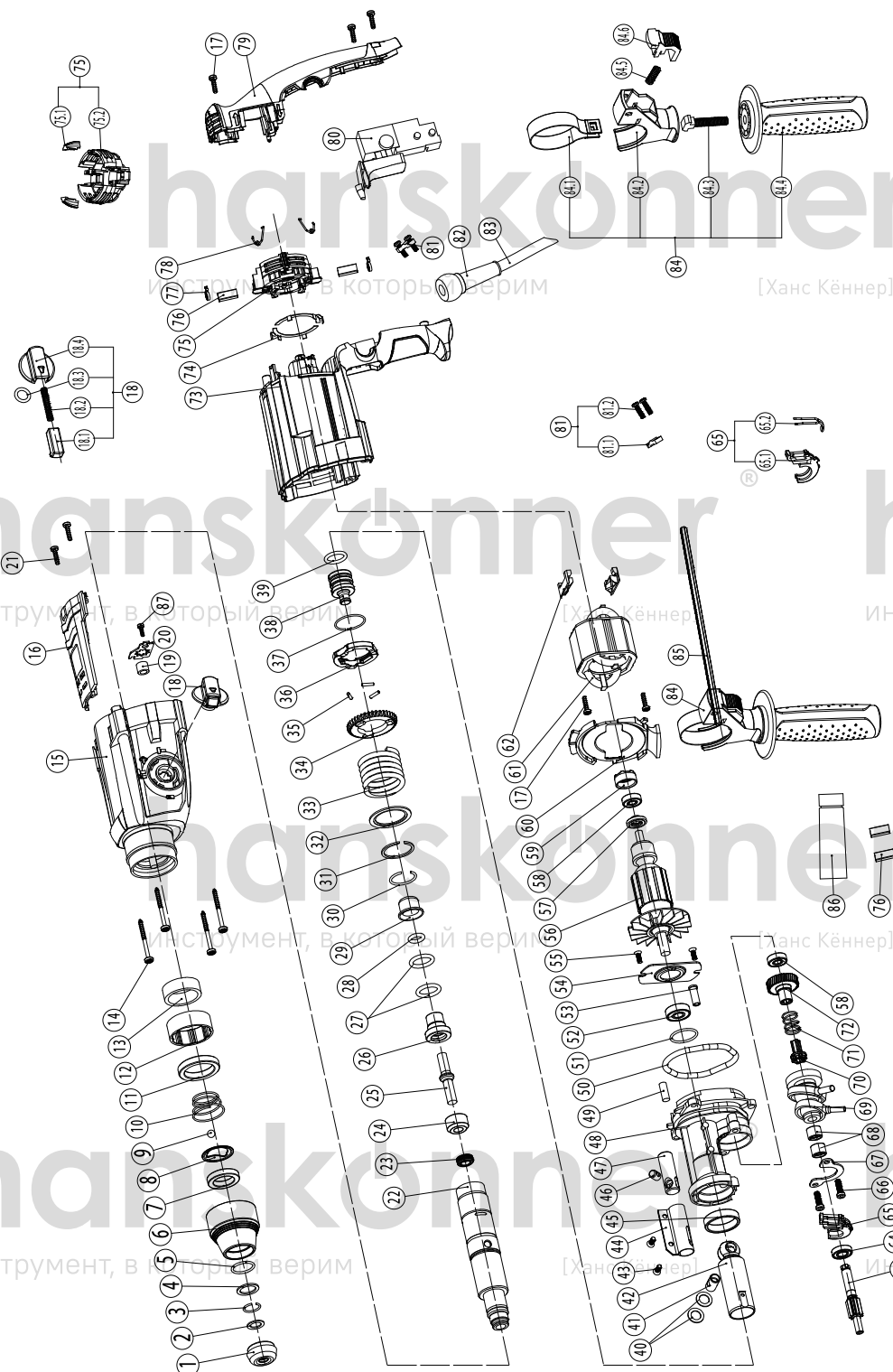

No.	Description	No.	Part Describe
1	DUST CAP	50	O-Ring ϕ 60x ϕ 5
2	Washer ϕ 17x ϕ 11.1x1	51	O-Ring ϕ 24x ϕ 2
3	CIRCLIP ϕ 16	52	Bearing 609RS
4	Washer ϕ 21.9x ϕ 16.1x1.4	53	Pin
5	CIRCLIP ϕ 22	54	Bearing Pressure plate
6	LOCKING SLEEVE	55	Screw M4x10
7	Lock Bead Sheath	56	Rotor
8	Support ring	57	INSULATION WASHER
9	ϕ 7.3 Steel ball	58	Bearing 607RS
10	spring	59	Bearing sleeve
11	Oil Seal Ring ϕ 30x ϕ 41x7	60	WIND GUIDE
12	Needle roller bearing steel sleeve	61	Stator
13	Needle Bearing HK3012	62	TERMINAL BOARD
14	Screw ST4.8x40	63	Middle gear
15	FRONT HOUSING	64	Bearing 699
16	decorative plate	65	Shift Fork module
17	Screw ST4.2x16	65.1	SHIFT FORK
18	Function Knob Subassembly	65.2	shift fork spring
18.1	LOCKING BUTTON	66	Bolt M5x12
18.2	spring	67	ROCKER BEARING PRESS PLATE
18.3	O-Ring ϕ 15.9X ϕ 2.65	68	Needle Bearing HK0910
18.4	Function Knob	69	Double ROCKER BEARING
19	Needle Bearing HK0709	70	CLUTCH
20	Nine teeth flower gaske	71	spring
21	Screw ST4.2x14	72	BEVEL GEAR
22	ROTARY SLEEVE	73	housing
23	Oil Seal ϕ 9x ϕ 16x5	74	SWITCH CONTACT
24	Impact rod Limit sleeve	75	Carbon Brush bracket assembly
25	Impact rod	75.1	reversing knob
26	Hammer Ring	75.2	Carbon Brush Support
27	O-Ring ϕ 3.5x ϕ 18	76	Carbon
28	O-Ring ϕ 3.5x ϕ 10	77	Coil spring
29	Locating Sleeve	78	Torsion spring
30	CIRCLIP ϕ 25	79	Handle Cover
31	CIRCLIP ϕ 28x 1.5	80	Switch
32	Washer ϕ 42 x ϕ 30 x 1.5	81	CORD CLAMP assembly
33	Spring	81.1	CORD CLAMP
34	Big gear	81.2	screw ST4.2X14
35	Pin ϕ 2.5 x 12	82	CORD SLEEVE
36	tripping gear seat	83	Cord
37	CIRCLIP ϕ 30x 1.5	84	AUXILIARY HANDLE assembly
38	Piston	84.1	HANDLE STEEL RING
39	O-Ring ϕ 17x ϕ 3	84.2	HANDLE SEAT
40	Washer ϕ 16x ϕ 10x1	84.3	T-Bolt
41	CYLINDER Pin	84.4	AUXILIARY HANDLE
42	CYLINDER	84.5	spring
43	screw M4X12	84.6	LOCK KNOB
44	Steel sleeve	85	DEPTH GUAGE
45	Bracket steel sleeve	86	Oil Bottle
46	Pin	87	Screw ST4.2X10
47	Counter weight block		
48	BRACKET		
49	WOOL FELT		